

- Tube Fitting (Double Ferrule)-  
 Tube To Male Pipe Thread

# Positionable Male Elbow

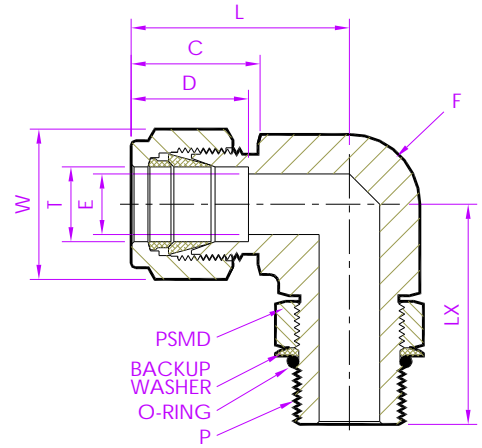

Fractional Tube x SAE/MS Straight (M)

Tubefit Part No.	Equivalent Part No. Type 1	Equivalent Part No. Type 2	TUBE OD Ø T	SAE/MS Male Pipe Size P	ØE	D	C	L	LX	Body Hex F	Nut Hex W
Dimensions in Inches											
4 - PMED - 7SM	- 400 - 2 - 4ST	4M5SEL4	1/4	7/16x20	0.19	0.60	0.70	1.12	1.12	9/16	9/16
4 - PMED - 9SM	- 400 - 2 - 6ST	-----		9/16x18	0.19			1.20	1.27	5/8	
5 - PMED - 8SM	- 500 - 2 - 5ST	-----	5/16	1/2x20	0.23	0.64	0.73	1.19	1.16	9/16	5/8
6 - PMED - 9SM	- 600 - 2 - 6ST	6M5SEL6	3/8	9/16x18	0.28	0.66	0.76	1.26	1.27	5/8	11/16
6 - PMED - 12SM	- 600 - 2 - 8ST	-----		3/4x16	0.28			1.37	1.49	13/16	
8 - PMED - 12SM	- 810 - 2 - 8ST	8M5SEL8	1/2	3/4x16	0.41	0.90	0.86	1.48	1.49	13/16	7/8
10 - PMED - 14SM	- 1010 - 2 - 10ST	-----	5/8	7/8x14	0.50	0.96	0.86	1.56	1.71	15/16	1
12 - PMED - 17SM	- 1210 - 2 - 12ST	12M5SEL12	3/4	1.1/16x12	0.62	0.96	0.86	1.63	1.92	1.1/16	1.1/8
14 - PMED - 19SM	- 1410 - 2 - 14ST	-----	7/8	1.3/16x12	0.72	1.02	0.86	1.70	1.99	1.3/16	1.1/4
16 - PMED - 21SM	- 1610 - 2 - 16ST	16M5SEL16	1	1.5/16x12	0.88	1.23	1.04	1.99	2.11	1.3/8	1.1/2

NOTE: 1)The E Dimension is the minimum opening & Fittings of this group may be back drilling to lager ID at pipe thread or straight thread end.  
 2)Dimension L, C, D is shown in the finger-tight position. 3)Dimensions are for reference only and are subject to change 4)SAE/MS (UNF) thread as per ASME B1.1.